

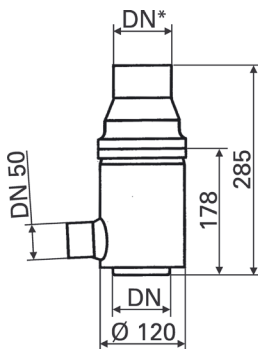

Engineering  
with nature

## Rainwater collector / Filter collector for the garden



- Collects the rainwater from the roof and feeds it to the rainwater barrel
- Designed for the installation in round vertical rainwater downpipes
- Eliminates all kind of debris with filter insert
- Functions as security overflow
- Top quality in stainless-steel, easy installed

WISY-Garden-Rainwater Collectors (GRS) are available for all nominal sizes of standard rainwater downpipes:

- for metal downpipes  
DN 76, DN 80, DN 87, DN 100
- for plastic downpipes  
DN 70 with external diameter Ø 75 mm (2,95 inch),  
DN 100 with external diameter Ø 110 mm (4,33 inch)

*Adaptions for UK- an US-sizes or others are available by request.*

### What is what?

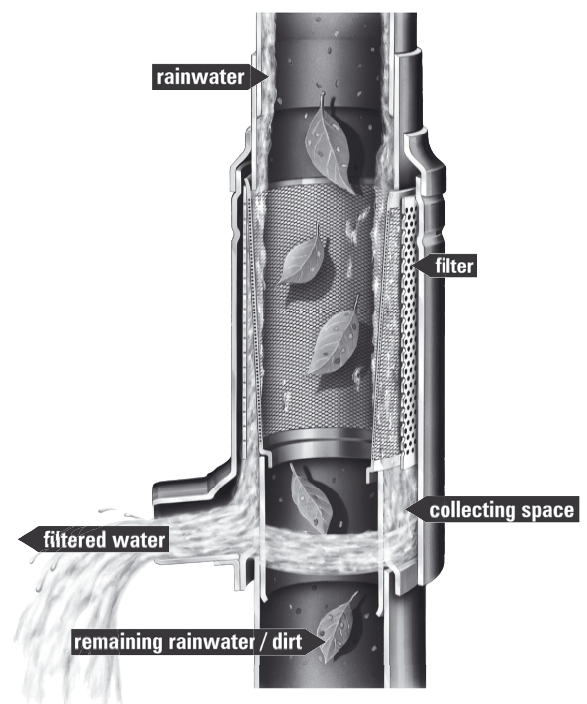
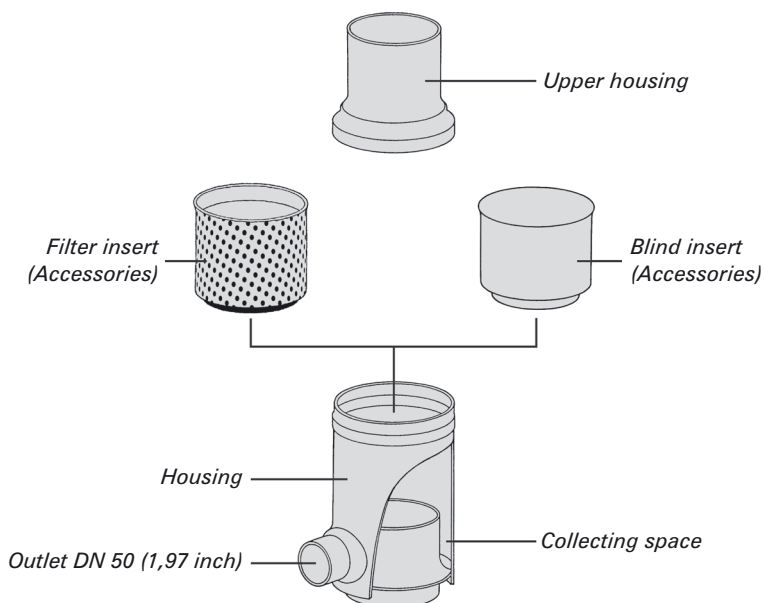

The design principle only works with round downpipes

\*DN= Nominal, internal diameter of a pipe (mm)

## Accessories

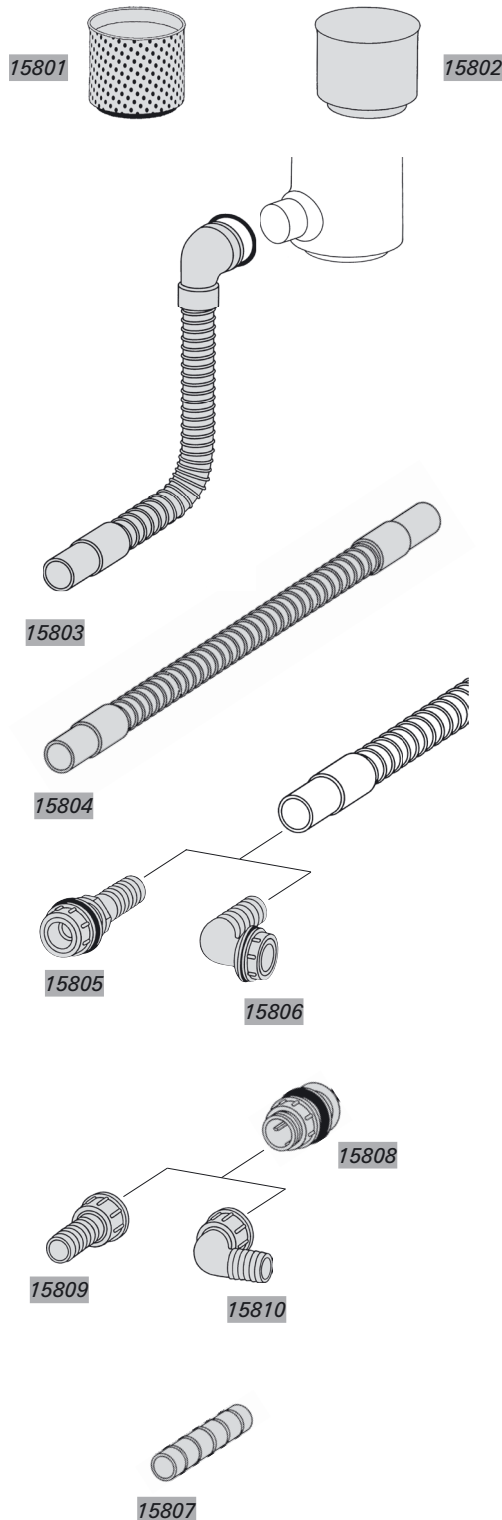

### Filter insert, mesh size 0,44 mm

The self-cleaning filter insert can be easily placed into the basic GRS. Passing through the vertical filter insert the rainwater from the roof will be cleaned in the GRS from debris > 0,44 mm. The barrel receives only filtered rainwater.

The unique WISY-construction will cause the dirt to be washed automatically to the drain.

**Art. No 15801** (fits for all sizes of GRS)

### Blind insert

The blind insert of stainless-steel stops the rainwater flowing from the GRS into the barrel. If you place the blind insert into the GRS-housing the rainwater will be diverted completely to the drain.

**Art. No 15802** (fits for all sizes of GRS)

### Connecting hose to the rain barrel

For connecting the GRS-outlet directly to a rainwater barrel. UV resistant, plastic spiral hose, total length 32 cm (9 inch) with tension ring.

**Art. No 15803**

### Link hose for several barrels

For joining one water barrel to another, UV resistant plastic spiral hose, total length 32 cm (9 inch).

**Art. No 15804**

### Tank connectors

For the direct connection of hoses at barrels.

**Art. No 15805** / Straight version, **Art. No 15806** / 90 ° version

### Tank connector, 1 1/4"

For thick-walled barrels.

For connection of straight or angled connectors.

**Art. No 15808**

### Connectors, 1 1/4"

For tank connector 15808.

**Art. No 15809** / Straight version, **Art. No 15810** / 90 ° version

### Hose coupling

For connecting two hoses.

**Art. No 15807**

Example in practice

